

STRIKES

CAL-ROYAL

ASA Strikes



CR-ASA478
US3, 10, 10B, 26, 32D
ASA Strike

CR-ASAST
US3, 26D
Steel ASA

DON-JO

STRIKES

Deadbolt Type ANSI Strike



<u>Stock No.</u>	<u>Finish</u>
DJ-BFD2 BP	Steel Brass Plated
DJ-BFD2 SL	Steel Silver Coated

4-7/8" X 1-1/4"
13ga. (.095)

Blank ANSI Strike



<u>Stock No.</u>	<u>Finish</u>
DJ-BS161 605	Solid Brass
\$DJ-BS161 612	Solid Bronze
DJ-BS161 626	Dull Chrome
DJ-BS161 630	Stainless Steel

4-7/8" X 1-1/4"
13ga. (.095)

\$-Discontinued. Call for closeout prices.

Deadbolt Strike



\$-Discontinued. Call for closeout prices.

<u>Stock No.</u>	<u>Finish</u>
\$DJ-DBS1478 605	Polished Brass
\$DJ-DBS1478 626	Satin Chrome

4-7/8" X 1-1/4"
13ga. (.095)

ASA Mortise Strikes



<u>Stock No.</u>	<u>Finish</u>
DJ-MST261 BP	Steel Brass Plated
DJ-MST261 SL	Steel Silver Coated

4-7/8" X 1-1/4"
13ga. (.095)

Standard ANSI Strike



4-7/8" X 1-1/4"
13ga. (.095)

<u>Stock No.</u>	<u>Finish</u>
DJ-ST161 605	Solid Brass Lacquered
DJ-ST161 612	Solid Bronze Lacquered
DJ-ST161 613	Duro Coated
DJ-ST161 625	Brass, Bright Chrome Plated
DJ-ST161 626	Brass, Dull Chrome Plated
DJ-ST161 630	Stainless Steel
<u>Stock No.</u>	<u>Finish</u>
DJ-ST261 BP	Steel Brass Plated
DJ-ST261 SL	Steel Silver Coated

T Strike



2-3/4" X 1-1/8"
18ga. (.050)

<u>Stock No.</u>	<u>Finish</u>
DJ-TS-234 605	Polished Brass
DJ-TS-234 630	Stainless Steel

STRIKES

DON-JO

STRIKES

2-1/4" Extended Lip Strike

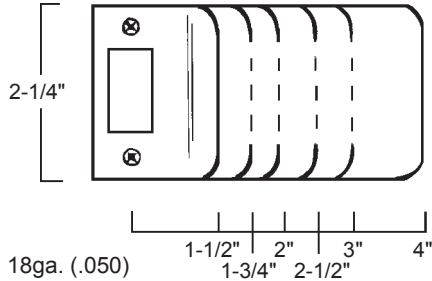

18ga. (.050)

Stock No.	Finishes	Size
DJ-EL102	605, 609, 619, 620, 630	2-1/4" x 2"
*DJ-9102	605, 609, 619, 620, 630	2-1/4" x 2"
DJ-EL103	605, 609, 630	2-1/4" x 3"
*DJ-9103	605, 630	2-1/4" x 3"
DJ-EL104	605, 609, 630	2-1/4" x 4"
DJ-EL115	605, 609, 619, 620, 630	2-1/4" x 1-1/2"
*DJ-9115	605, 609, 619, 620, 630	2-1/4" x 1-1/2"
DJ-EL125	605, 609, 630	2-1/4" x 2-1/2"
*DJ-9125	605	2-1/4" x 2-1/2"
DJ-EL175	605, 609, 619, 620, 630	2-1/4" x 1-3/4"
*DJ-9175	605, 619, 620, 630	2-1/4" x 1-3/4"

***SAVE MONEY: DJ-9102, DJ-9103, DJ-9115, DJ-9125 and DJ-9175 are polybagged and sold in multiples of 10.**

2-3/4" Extended Lip Strike

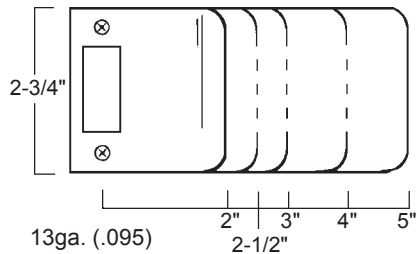

13ga. (.095)

Stock No.	Finishes	Size
DJ-EL202	BP	2-3/4" x 2"
DJ-EL203	BP	2-3/4" x 3"
DJ-EL204	BP	2-3/4" x 4"
DJ-EL205	BP	2-3/4" x 5"
DJ-EL225	BP	2-3/4" x 2-1/2"

Don Jo Finishes:

605	Bright Brass
609	Antique Brass
612	Satin Bronze
619	Satin Nickel
620	Antique Nickel
630	Satin Stainless Steel
BP	Brass Plated

4-7/8" Extended Lip ANSI Strike

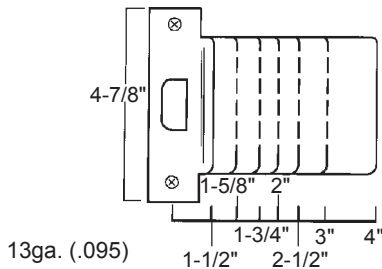

13ga. (.095)

Stock No.	Finishes	Size
DJ-EST102	605, 612, 630	4-7/8" x 2"
DJ-EST103	605, 612, 630	4-7/8" x 3"
DJ-EST104	605, 612, 630	4-7/8" x 4"
DJ-EST115	605, 612, 630	4-7/8" x 1-1/2"
DJ-EST125	605, 612, 630	4-7/8" x 2-1/2"
DJ-EST158	630	4-7/8" x 1-5/8"
DJ-EST175	605, 612, 630	4-7/8" x 1-3/4"

2-3/4" Extended Lip T-Strike

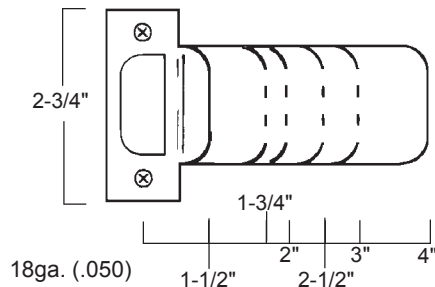

18ga. (.050)

Stock No.	Finishes	Size
DJ-ETS102	605, 609, 630	2-3/4" x 2"
DJ-ETS103	605, 609, 630	2-3/4" x 3"
DJ-ETS104	605, 609, 630	2-3/4" x 4"
DJ-ETS115	605, 609, 630	2-3/4" x 1-1/2"
DJ-ETS125	605, 609, 630	2-3/4" x 2-1/2"
DJ-ETS175	605, 609, 630	2-3/4" x 1-3/4"

Security Strikes - display packed



DJ-2SDS

For Deadbolt



DJ-2SS

For Key-in-knob



DJ-2SDS 8

Super strike for deadbolt

Stock No.	Finish	Size
DJ-2SDS BP	Steel Brass Plated	4-7/8" x 1-1/4"
DJ-2SDS SL	Steel Silver Coated	4-7/8" x 1-1/4"
DJ-2SS BP	Steel Brass Plated	4-7/8" x 1-1/4"
DJ-2SS SL	Steel Silver Coated	4-7/8" x 1-1/4"
DJ-2SDS 8 BP	Steel Brass Plated	8" x 1-3/8"
DJ-2SDS 8 SL	Steel Silver Coated	8" x 1-3/8"

13 ga. (.095). Supplied with four 3" screws for extra security.

©ZIPF LOCK COMPANY

STRIKES

DON-JO

STRIKES

SERIES 8 STRIKE

Single Hole Version

Single hole version designed to work with key-in-knob or dead-bolt.

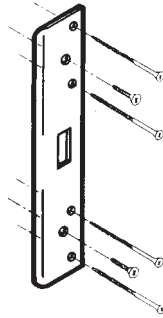

Stock No.

DJ-FL208N BP
DJ-FL208W BP
DJ-FL208W SL
DJ-FL208W WH

Finish

Brass Plated
 Brass Plated
 Silver Coated
 White Coated

Size

8" X 1-3/8"
 8" X 1-3/4"
 8" X 1-3/4"
 8" X 1-3/4"

SERIES 12 STRIKE

Single Hole Version

Single hole version designed to work with key-in-knob or dead-bolt.

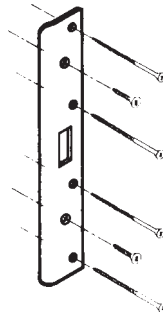

Stock No.

DJ-FL212N BP
DJ-FL212W BP
DJ-FL212W SL
DJ-FL212W WH

Finish

Brass Plated
 Brass Plated
 Silver Coated
 White Coated

Size

12" X 1-3/8"
 12" X 1-3/4"
 12" X 1-3/4"
 12" X 1-3/4"

Double Hole Version

Double hole version designed to accommodate both 3-5/8" and 4" centered locksets.

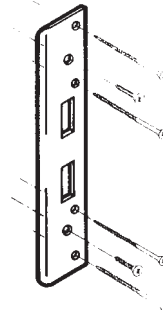

Stock No.

DJ-FL212N4 BP
DJ-FL212W4 BP
DJ-FL212W4 SL
DJ-FL212W4 WH

Finish

Brass Plated
 Brass Plated
 Silver Coated
 White Coated

Size

12" X 1-3/8"
 12" X 1-3/4"
 12" X 1-3/4"
 12" X 1-3/4"

Double Hole Version

Double hole version designed to accommodate 6" center holes.

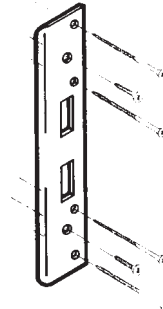

Stock No.

DJ-FL212N6 BP
DJ-FL212N6 SL
DJ-FL212W6 BP
DJ-FL212W6 SL
DJ-FL212W6 WH

Finish

Brass Plated
 Silver Coated
 Brass Plated
 Silver Coated
 White Coated

Size

12" X 1-3/8"
 12" X 1-3/8"
 12" X 1-3/4"
 12" X 1-3/4"
 12" X 1-3/4"

SERIES 18 STRIKE

Single Hole Version

Single hole version designed to work with key-in-knob or dead-bolt.

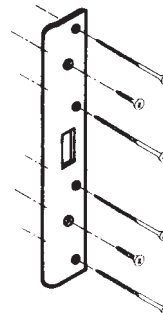

Stock No.

DJ-AST21341 BP
DJ-AST21341 SL
DJ-AST21381 BP

Finish

Brass Plated
 Silver Coated
 Brass Plated

Size

18" X 1-3/4"
 18" X 1-3/4"
 18" X 1-3/8"

STRIKES

DON-JO

STRIKES

SERIES 18 STRIKE

Double Hole Version

Double hole version designed to accommodate both 3-5/8" and 4" centered locksets.

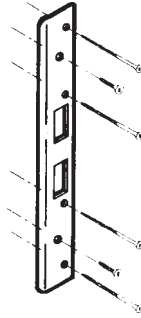

<u>Stock No.</u>	<u>Finish</u>	<u>Size</u>
DJ-AST21342 BP	Brass Plated	18" X 1-3/4"
DJ-AST21342 SL	Silver Coated	18" X 1-3/4"
DJ-AST21382 BP	Brass Plated	18" X 1-3/8"

Double Hole Version

Double hole version designed to accommodate 6" center holes.

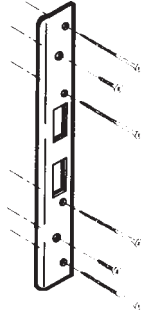

<u>Stock No.</u>	<u>Finish</u>	<u>Size</u>
DJ-AST21346 BP	Brass Plated	18" X 1-3/4"
DJ-AST21346 SL	Silver Coated	18" X 1-3/4"
DJ-AST21346 WH	White Coated	18" X 1-3/4"
DJ-AST21386 BP	Brass Plated	18" X 1-3/8"

Mortise Lock Version

Mortise hole version with "universal" center hole.

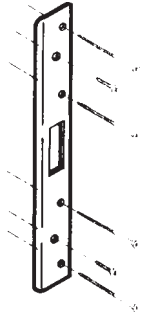

<u>Stock No.</u>	<u>Finish</u>	<u>Size</u>
DJ-AST2134M BP	Brass Plated	18" X 1-3/4"
DJ-AST2134M SL	Silver Coated	18" X 1-3/4"

ADJUSTABLE SECURITY STRIKE

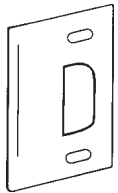

DJ-A2SS



DJ-A2SDS

<u>Stock No.</u>	<u>Size</u>	<u>Description</u>	<u>Finish</u>
DJ-A2SS BP	3-3/8" X 1-3/4"	Key in knob strike	Steel Brass Plated
DJ-A2SS SL	3-3/8" X 1-3/4"	Key in knob strike	Steel Silver Coated
DJ-A2SDS BP	3-3/8" X 1-1/4"	Deadbolt strike	Steel Brass Plated
DJ-A2SDS SL	3-3/8" X 1-1/4"	Deadbolt strike	Steel Silver Coated

STRIKES

STRIKES FOR:

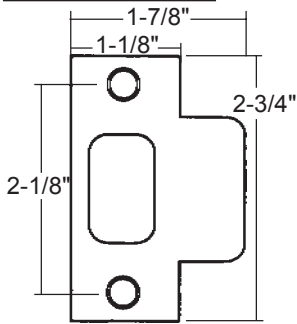

KW-83028 US-3, 26D
Metal Jamb Strike (TMS)
Not available on deadlocks

Kwikset
UltraMax
Signatures

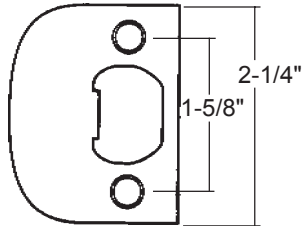

KW-83437
US-3, 5, 10B, 15, 15A, 26D
Standard Lockset Strike

Kwikset
Maximum
SECURITY

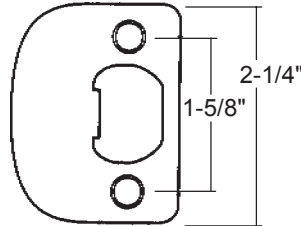

KW-83796
US-3, 5, 10B, 15, 15A, 26D
1/4" Radius Strike (RCS-4)

Kwikset
Security

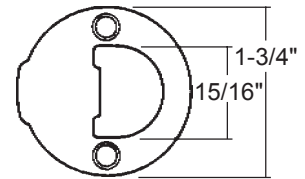

KW-83929 US-3, 5
Full round 1-3/4" metal jamb strike (includes metal and wood screws)

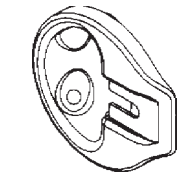
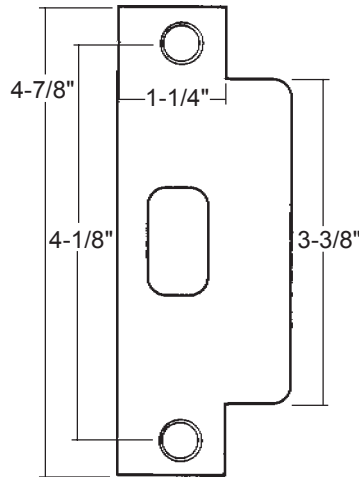

KW-80318 US-3, 5, 26D
Full round adjustable strike.

KW-83846 US-3, 26D
Metal Jamb Strike
1-1/4" x 4-7/8" ANSI
Not available on deadlocks

FINISHES:

US-3 (605)	Polished Brass
US-LO3 (605E)	Polished Brass-Life
US-5 (609)	Antique Brass
US-10B (613)	Oil Rubbed Bronze
US-15(619)	Satin Nickel
US-15A (620)	Antique Nickel
US-26 (625)	Polished Chrome
US-26D (626)	Satin Chrome

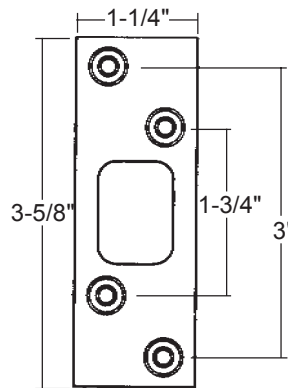

KW-83222 US-3, 26D
780, 785, 970, 975, 980, 985

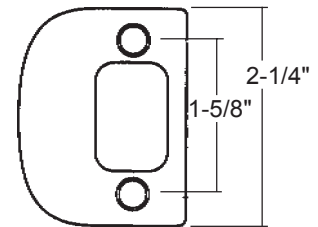

KW-84638 US-3, 5, 26D
Deadbolt strike with lip

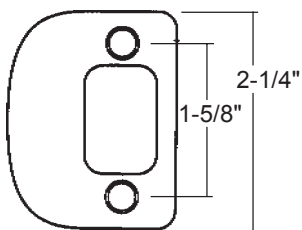

KW-85303 US-10B, 15, 15A
Deadbolt strike with lip. 1/4" radius corners.

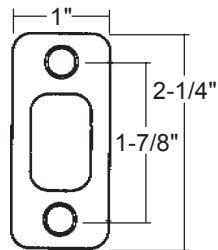

KW-85063
US-3, 5, 15, 15A, 26D
660 Series Deadlock Strike
Round corner strike

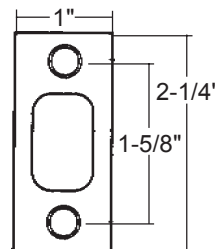



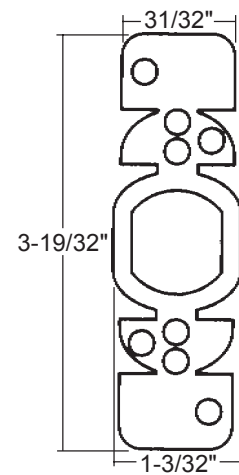

KW-85072 US-3, 5, 26D
660 Series Deadlock Strike
Square corner strike

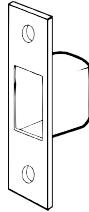
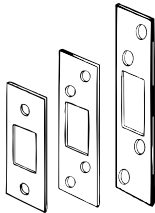
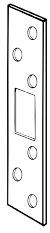

KW-81640 Strike Box
Plastic door jamb deadbolt strike insert for cleaner installation

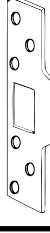

SECURITY STRIKES

PART NO.	FINISH	DOOR THICKNESS	OVERALL SIZE	SHELF PACK	MASTER PACK	UPC (015231)	PRODUCT DESCRIPTION
747-B	Brass	ALL	1-1/4" x 4-7/8"	5	50	07473 7	 HEAVY DUTY HIGH SECURITY BOX STRIKE With 2" Long Screws to Secure Box to Stud 16 GA. with 18 GA. Faceplate (Carded)
747-C	Chrome					07472 0	
750-B	Brass	ALL	1-1/4" x 3-5/8"	5	50	07503 1	 SECURITY DEADBOLT STRIKE With 1-1/4" and 3" Long Screws to Secure Strike to Stud 13 GA. and 16 GA. (Carded or Bulk) (#750 - Kwikset Replacement)
750-B200	Brass	ALL	1-1/4" x 3-5/8"	1	1	N/A NEW! 200 Pcs. Bulk	
755-B	Brass	ALL	1-1/4" x 4-7/8"	5	50	07553 6	
760-B	Brass	ALL	1-1/8" x 6"	5	50	07603 8	 HEAVY GAUGE DEADBOLT STRIKE With 1-1/2" Long Screws, Secures Strike to Stud 13 GA. (Carded)
760-C	Chrome					07602 1	
765-B	Brass	1-3/4" or thicker	1-5/8" x 7-3/4"	5	50	07653 3	 HEAVY GAUGE DEADBOLT STRIKE With 1-1/4" and 3" Long Screws Secures Strike to Stud 13 GA. (Carded)
770-B	Brass	ALL	1-1/4" x 8"	5	50	07703 5	 HEAVY GAUGE LIP STRIKE With 1-1/4" and 3" Long Screws Secures Strike to Stud 13 GA. (Carded)
775-B	Brass	1-3/4" or thicker	1-5/8" x 11"	5	40	07753 0	 HEAVY GAUGE DOUBLE STRIKE With 1-1/4" and 3" Long Screws Secures Strike to Stud 3-5/8" to 4" Centers 13 GA. (Carded)
776-B	Brass	1-3/4" or thicker	1-5/8" x 11"	5	40	07763 9	 HEAVY GAUGE DOUBLE STRIKE With 1-1/4" and 3" Long Screws For 1-3/4" Doors, for Double Locks with 5-1/2" to 6" Centers 13 GA. (Carded)

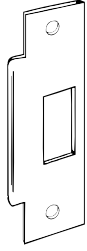
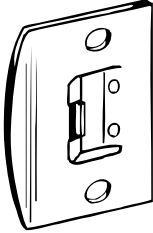
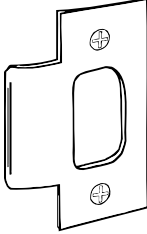

ORDERS SHIP within 3-5 Business Days

All items to be ordered in shelf pack quantities.

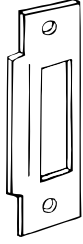
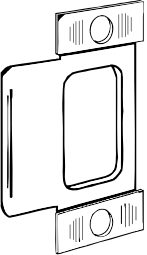
DON'T FORGET WE ALSO RAPIDLY CUSTOMIZE STRIKES, KICK PLATES AND PUSH PLATES FOR ORDERS OF ANY SIZE. FAX OR EMAIL A DRAWING FOR A QUICK QUOTE.

PRODUCT DESCRIPTION	PART NO.	FINISH	DOOR THICKNESS	OVERALL SIZE	SHELF PACK	MASTER PACK	UPC (015231)
LARGE LIP STRIKE  With 2" Long Screws 18 GA. (Carded or Bulk)	Carded						
	721-B 721-C	Brass Chrome	ALL	1-1/4" x 4-7/8"	5	50	07213 9 07212 2
	200 Pcs. Bulk						
	NEW 721-B200	Brass	ALL	1-1/4" x 4-7/8"	1	1	N/A
EMERGENCY DOOR LOCK RELEASE STRIKE  For Use on Interior Doors Only. Moderate Force Opens Interior Doors without Damage. 1-1/8" x 2-1/4" 18 GA. (Carded)	720-B	Brass	ALL	1-1/8" x 2-1/4"	5	50	07203 0
REPLACEMENT T-STRIKE  1-1/8" x 2-3/4" 18 GA. (Carded)	722-B 722-C	Brass Chrome	ALL	1-1/8" x 2-3/4"	5	50	07223 8 07222 1
STANDARD ASA STRIKE  1-1/4" x 4-7/8" 13 GA. (Carded)	731-PB 731-S	Polished Brass Stainless Steel	ALL	1-1/4" x 4-7/8"	5	50	07313 6 07312 9
ASA MORTISE STRIKE  1-1/4" x 4-7/8" 13 GA. (Polybagged - Bulk)	32-CB	Chrome	ALL	1-1/4" x 4-7/8"	25	100	00322 5
ADJUST-A-STRIKE  2-3/4" Adjust-A-Strike For Wood Frames with 1/4" Adjustment 14 GA. U.S. Pat 4,492,397 (Carded)	450-B	Brass	NA	1-1/4" x 2-3/4"	5	50	04503 4

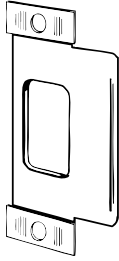
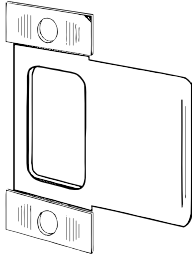
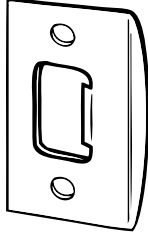
SECURITY STRIKES AND ADJUSTABLE STRIKES

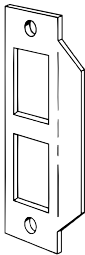
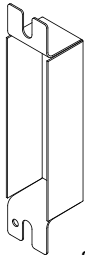
PART NO.	FINISH	DOOR THICKNESS	OVERALL SIZE	SHELF PACK	MASTER PACK	UPC (015231)	PRODUCT DESCRIPTION
452-B	Brass	NA	1-1/4" x 4-7/8"	5	50	04523 2	 <p>ADJUST-A-STRIKE</p> <p>4-7/8" Adjust-A-Strike For Wood Frames with 1/4" Adjustment 14 GA. U.S. Pat 4,492,397 (Carded)</p>
4520-B	Brass	NA	2" Lip	5	50	45203 0	 <p>EXTENDED LIP ADJUST-A-STRIKE</p> <p>2-3/4" Extended Lip Adjust-A-Strike For Wood Frames with 1/4" Adjustment. 14 GA U.S. Pat 4,492,397 (Carded)</p>
4525-B	Brass	NA	2-1/2" Lip	5	50	45253 5	
718-AB 718-B 718-C	Antique Brass Brass Chrome	NA	1-1/8" x 2-1/4"	5	50	2 Per Card 07185 9 07183 5 07182 8	 <p>REPLACEMENT LIP STRIKE</p> <p>Full Lip For Use on Entry or Interior Doors, Adjustable Tang Replacement Strike for Kwikset, Schlage® Weiser and Most Other Brands 18 GA (1 or 2 Per Card)</p>
716-B	Brass	NA	1-1/8" x 2-1/4"	5	50	1 Per Card 07163 7	
717-B2	Brass	NA	1-1/8" x 2-1/4"	1	4	20 pieces in 1 polybag N/A	 <p>REPLACEMENT LIP STRIKE</p> <p>Full Lip, for Use on Entry or Interior Doors, Adjustable Tang. 18 GA (Bulk – 20 pieces per bag 717-B2 OR 20 pieces individually bagged in a retail display 717-B20)</p>
717-B20	Brass	NA	1-1/8" x 2-1/4"	1	4	Display 20 pieces ind. wrapped 97183 8	
8781	Brass	NA	1-5/16" x 3-5/16"	5	50	87813 7	 <p>REPLACEMENT STRIKE</p> <p>For Bit Key Mortise Lock 3/4" Lip Fits Part #'s 8783, 8785, 8786 and 8787 18 GA. (Carded)</p>
745	Steel	NA	1" x 4-7/8"	NA	50	NA	 <p>DUST PROOF STRIKE BOX</p> <p>NEW!</p> <p>22 guage steel provides more protection for the extended bolt and adds some rigidity to the strike (Bulk Box)</p>

ORDERS SHIP within 3-5 Business Days

All items to be ordered in shelf pack quantities. 23

DON'T FORGET WE ALSO RAPIDLY CUSTOMIZE STRIKES, KICK PLATES AND PUSH PLATES FOR ORDERS OF ANY SIZE. FAX OR EMAIL A DRAWING FOR A QUICK QUOTE.

STRIKES



WELDABLE GATE BOXES

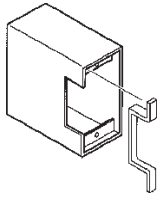

KD-K-BXES1

For installing Trine 005 and Rofu 1106 electric strikes.

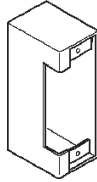

KD-K-BXES2

For installing Rofu 1402, 1702 and 3402 electric strikes. Also Rutherford 7 Series.

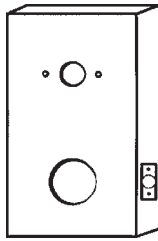

KD-K-BXSIM

For installing Simplex/Unican 1000 Series.



Stock No.

MAG-747-3

Finish

Brass

The ONLY strike to use when installing deadbolts.

- For use with any deadbolt. (Box is 1-5/8" high x 3/4" wide x 1-1/4" deep).
- Standard ASA 1-1/4" x 4-7/8".
- One piece construction.
- Secured by 4—2" long hardened screws.
- 2 screws at bottom of box are offset and installed at a 25° angle allowing screws to enter the stud closer to the center for maximum holding strength. Prevents bolts from being pushed in with punch.
- Box made of heavy 16 gauge steel.

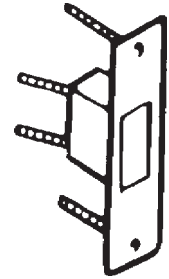

ADJUST-A-STRIKE

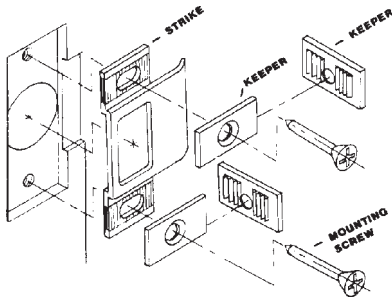

This strike eliminates door rattle, bind on lock bolt, and provides for a snug fit against weather-strip for energy conservation.

Stock No.

MAG-450-B

Finish

Brass

2-3/4" x 1-1/4" Lip Strike

Stock No.

MAG-454-C

Finish

Chrome

4-7/8" x 1-1/4" Lip Strike For Metal Frame

Stock No.

MAG-721-B

Finish

Brass

Large Lip Strike with 2" screws.(4-7/8" x 1-1/4").

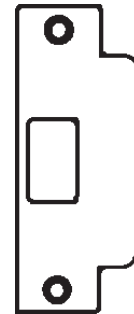
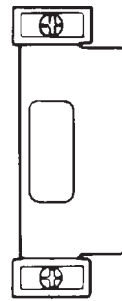
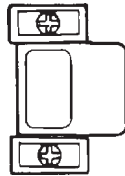

progressive

SECURITY STRIKES

- Heavy gauge steel.
- Brass plated.
- Supplied with 1-1/2" screws.
- Individual poly bagged.

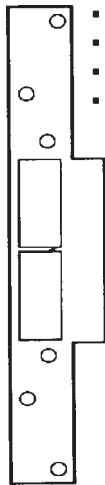

PG-9620

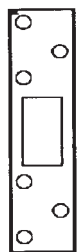

PG-9630

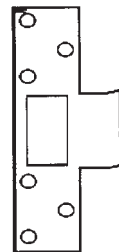

PG-9640

Stock No.

PG-9620

Size

10" x 1-1/4"

PG-9630

5-7/8" x 1-1/8"

PG-9640

5-7/8" x 1-1/8"

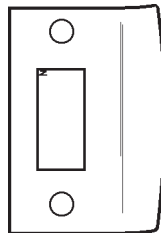

\$PG-73

Passage Strike-Curved Lip Brass Plated

\$-Discontinued. Call for closeout prices



FLUSH BOLT STRIKE—

Dust Proof Strikes - Threshold Only

- Designed for use with the bottom bolt of the Ives extension flush bolts on non-fire rated openings. For installation in thresholds up to 1/4" thick.
- 3/4" diameter plunger accepts up to 5/8" diameter round bolts or 1/2" square bolts.
- Can be locked in up position by rotating plunger with screwdriver or coin. Eliminates trapping of spiked heels.
- Made from polished wrought brass.
- Dimensions:
Faceplate: 1-3/8" Diameter
Body: 1-61/64" Overall Depth,
Fits Hole 1-1/16" in Dia.

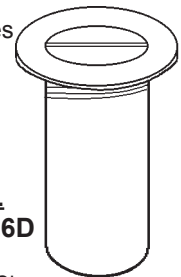

Stock No.

IV-DP3 26D

Finish:

26D Satin Chrome

STRIKES

STRIKES



SC-10-001

605, 612, 613, 626
Standard Strike

SIZE: 2-3/4" x 1-1/8" x 3/32"

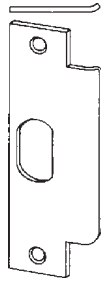

SC-10-025

605, 612, 613, 626
Strike for ANSI preparation
SIZE: 4-7/8" x 1-1/4" x 3/32"

SCHLAGE

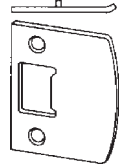

SC-10-026

605, 626
Full Lip Standard Strike



SC-10-058

605

Circular, adjustable
1-3/4" diameter
deadlatch strike

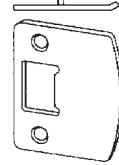

SC-10-027

605, 626
1/4" Radius Rounded
Corner Full Lip Strike

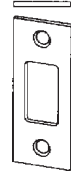

SC-10-094

605, 626
BC160, B360, BR260
Standard Strike
Square Corner

Finishes:

605 Bright Brass

612 Satin Bronze

613 Oil Rubbed Bronze

626 Satin Chrome